

New Dimension

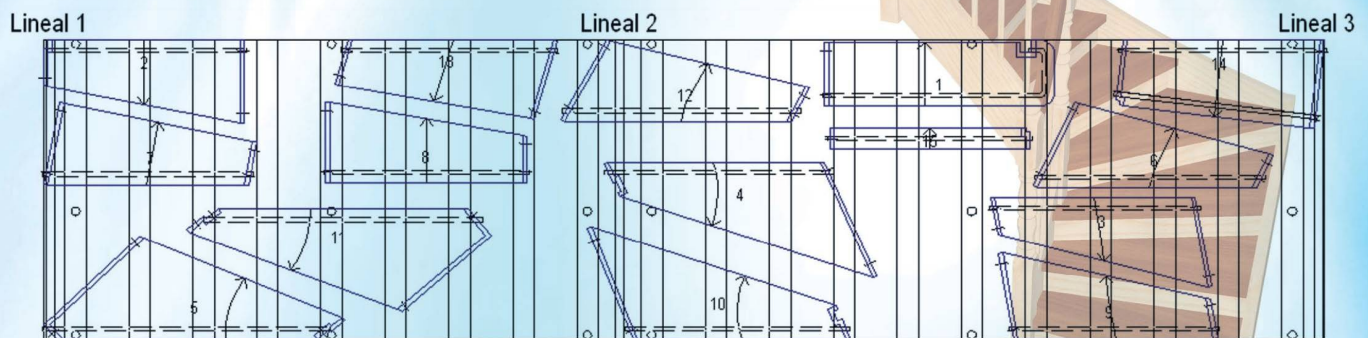
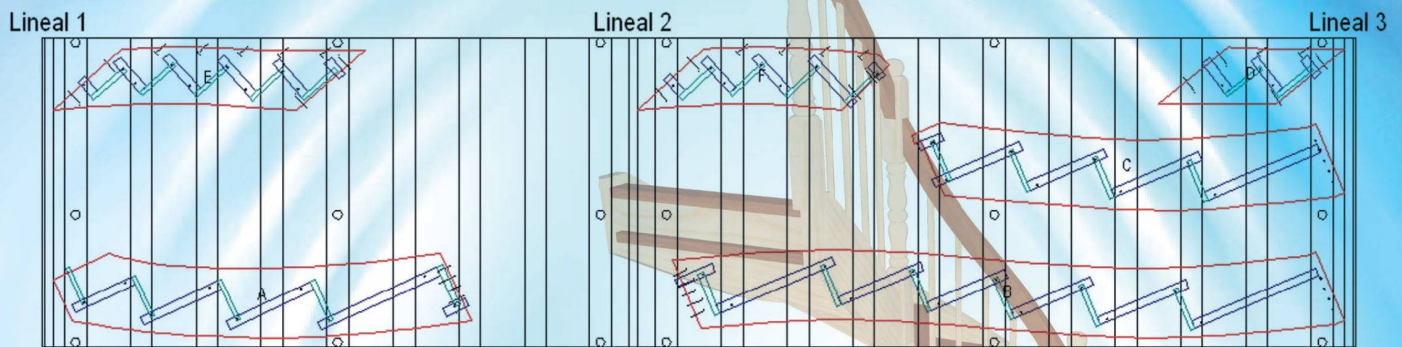
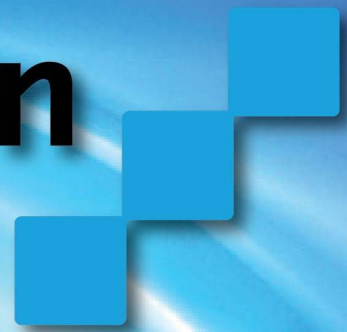

Staircase-Software Programs

Table

Software module for positioning stair parts on a machine Table for optimization of workings

Article no. 00323901

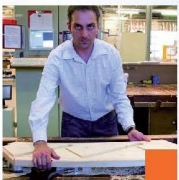

producing

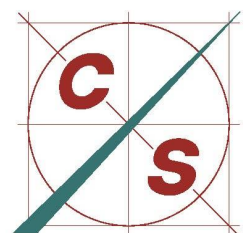

Compass Software

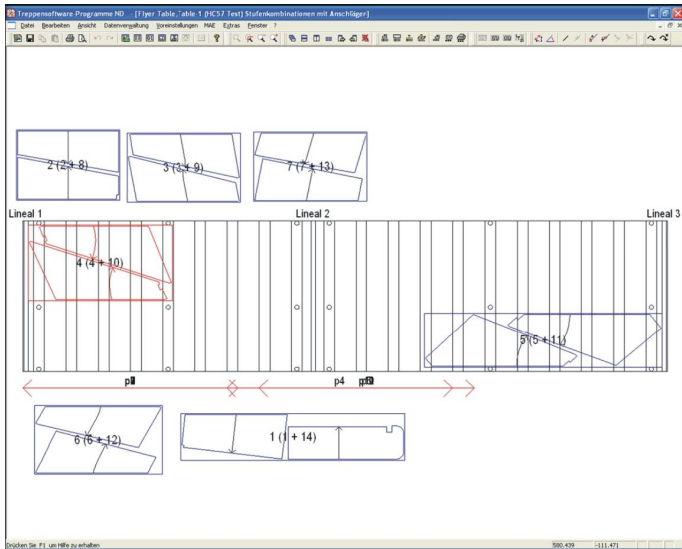

The software module Table enables the user to prepare complete machine Table configurations of stair parts interactively at the computer. These will be processed on the machine as one CNC-program with optimized tool changes to save time. There will be placed always the same kind of parts (treads, strings, ...). An optimization of the tool path between the different parts is achieved by a „shortest way algorithm“, but this is calculated on the parts, not on the tool path.

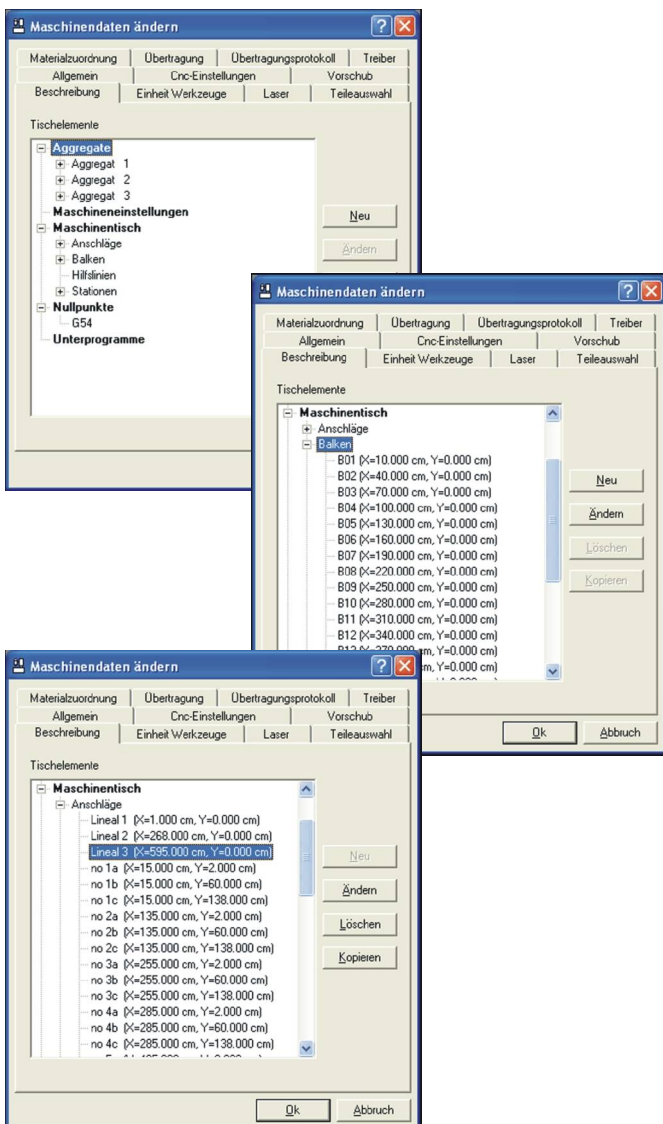

The machine Table is configured in the properties of the machine. For example you can define a closed Table with or without stopps or you define a Table with bars with or without stopps. During placing the stair parts in front of the screen you have complete control how and where to place the parts. If you use stopps the parts jump from one stopp to the next by moving the mouse until you fix them. Without stopps you can move the parts continuously on the Table and fix them at any place. The exact positions on the real Table can be shown with a con-tour laser for positioning the vacuum cups manually.

In connection with the automatic vacuum positioning (Article no.: 00311401) you get a first proposal for the cup positioning for the whole Table from the system. After that you can also move the bars and cups on the bars interactively on the screen. Also these are defined in the properties of the machine and later on the machine they are automatically positioned by the CNC-program. By this you get a highly sophisticated use of the machine Table with a maximum of automatization.

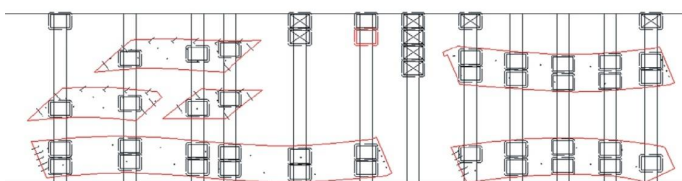

With placing the individual parts you have different possibilities of manipulation. So you can turn run-parts (strings, handrails etc.) by 180°. The same with treads, which can be mirrored in addition, if it is not necessary to have a certain surface on top.

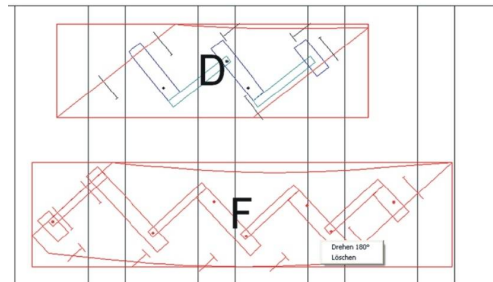

In the order tree you can define so called production groups from different stairs even from different orders. All these parts can get a number (for serial production). On these production groups you have the same functionality corresponding to positioning and workings as described above for single stairs.

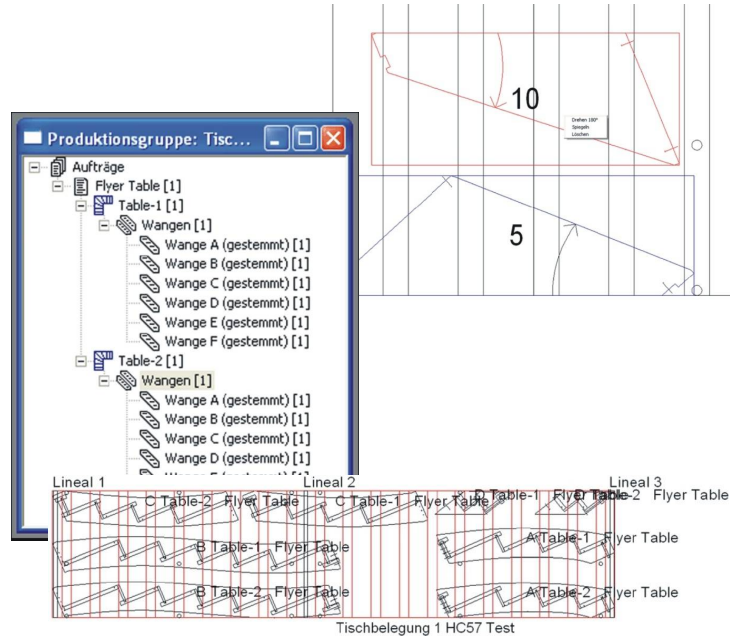

The following placements are possible:

- Strings without stops
- Strings with stops

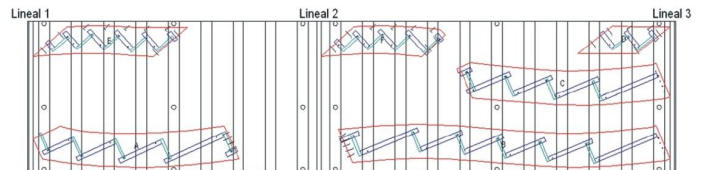

- Handrails with stops



- Treads without stops
- Treads with stops

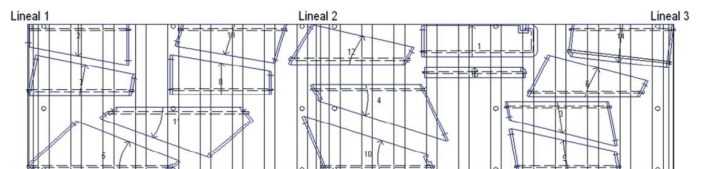

- Tread combinations with stopps

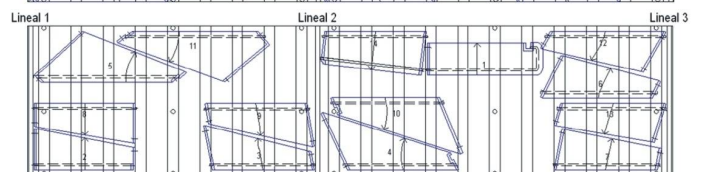

- Risers with stopps

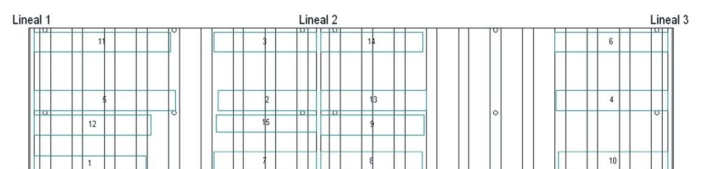

Article no. 00323901

Option CAM/CNC Table

Precondition:

CAM/CNC Basis (Article 00310001) or

CAM/CNC 3-axes (Article 00311001) or

CAM/CNC 4-axes (Article 00312001) or

CAM/CNC 5-axes (Article 00313001)

CAD SSP ND (Article 00119301, 00119401, 00119501)

Compass Software GmbH

Steinhammerstr. 140 a

44379 Dortmund

Tel.: +49 (0) 2 31 98 12 90-0

Fax: +49 (0) 2 31 98 12 90-10

Web: www.compass-software.de

Mail: mail@compass-software.de

© Compass Software GmbH 2009

All rights reserved

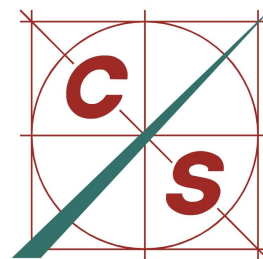

Compass Software